

LEGEND:

- 1/2" IRON PIPE
- PERMANENT MONUMENT
- (R) RADIAL LINE
- S— PROPOSED SANITARY SEWER
- PROPOSED LOCATION OF SEWER LATERAL
- PROPOSED SAN. SEWER MANHOLE BASED ON DESIGN PLAN
- (XXX.XX TC) PROPOSED TOP OF CURB EL. BASED ON DESIGN PLAN
- ∞— MINIMUM FINISHED FLOOR
- ∞— FLOW LINE OF SWALE
- (A) GRADE 1.0" DEEP, V BOTTOM SWALE W/5:1 SIDE SLOPES AT 1.0% MIN.
- TC TOP OF CURB
- FG FINISH GRADE

CERTIFICATION:

I HEREBY CERTIFY THAT THE ABOVE LOT WAS SURVEYED UNDER MY DIRECTION. I FURTHER STATE THAT THE ABOVE LOT DOES NOT LIE WITHIN THE 100 YEAR FLOOD PLAIN AS ADOPTED BY THE CITY OF COLUMBIA, MISSOURI.

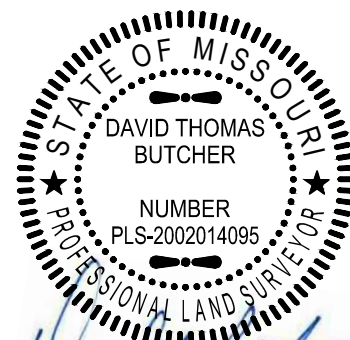

David T. Butcher

DAVID T. BUTCHER, PLS-2002014095
 12/10/2021
 DATE

DESCRIPTION:

LOT 336 OF THE VINEYARDS PLAT No. 3, RECORDED IN PLAT BOOK 50, PAGE 67, LOCATED IN COLUMBIA, BOONE COUNTY, MISSOURI.

CROCKETT
ENGINEERING CONSULTANTS
 1000 W. Nifong Blvd., Building 1
 Columbia, Missouri 65203
 (573) 447-0292
 www.crockettengineering.com

CORPORATE NUMBER: 2000151304	
DATE: 11/14/2016	SCALE: 1" = 20'
PROJECT: 041371	DRAWN BY: KWF

THE VINEYARDS, PLAT No. 3
PLOT PLAN LOT 336 SECTION 21, TOWNSHIP 48 NORTH, RANGE 12 WEST COLUMBIA, BOONE COUNTY, MISSOURI
ADDRESS: