

# PLOT PLAN

## LOT 236

LOT FALLS WITHIN THE RIM OF SINKHOLE AND A SITE SPECIFIC GEOTECHNICAL INVESTIGATION REPORT HAS BEEN COMPLETED FOR THIS LOT. COPIES OF THE GEOTECHNICAL REPORT ARE MADE AVAILABLE IF NEEDED.

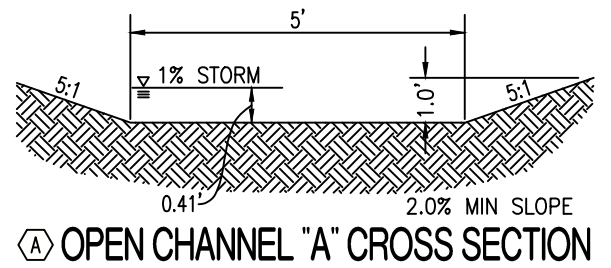
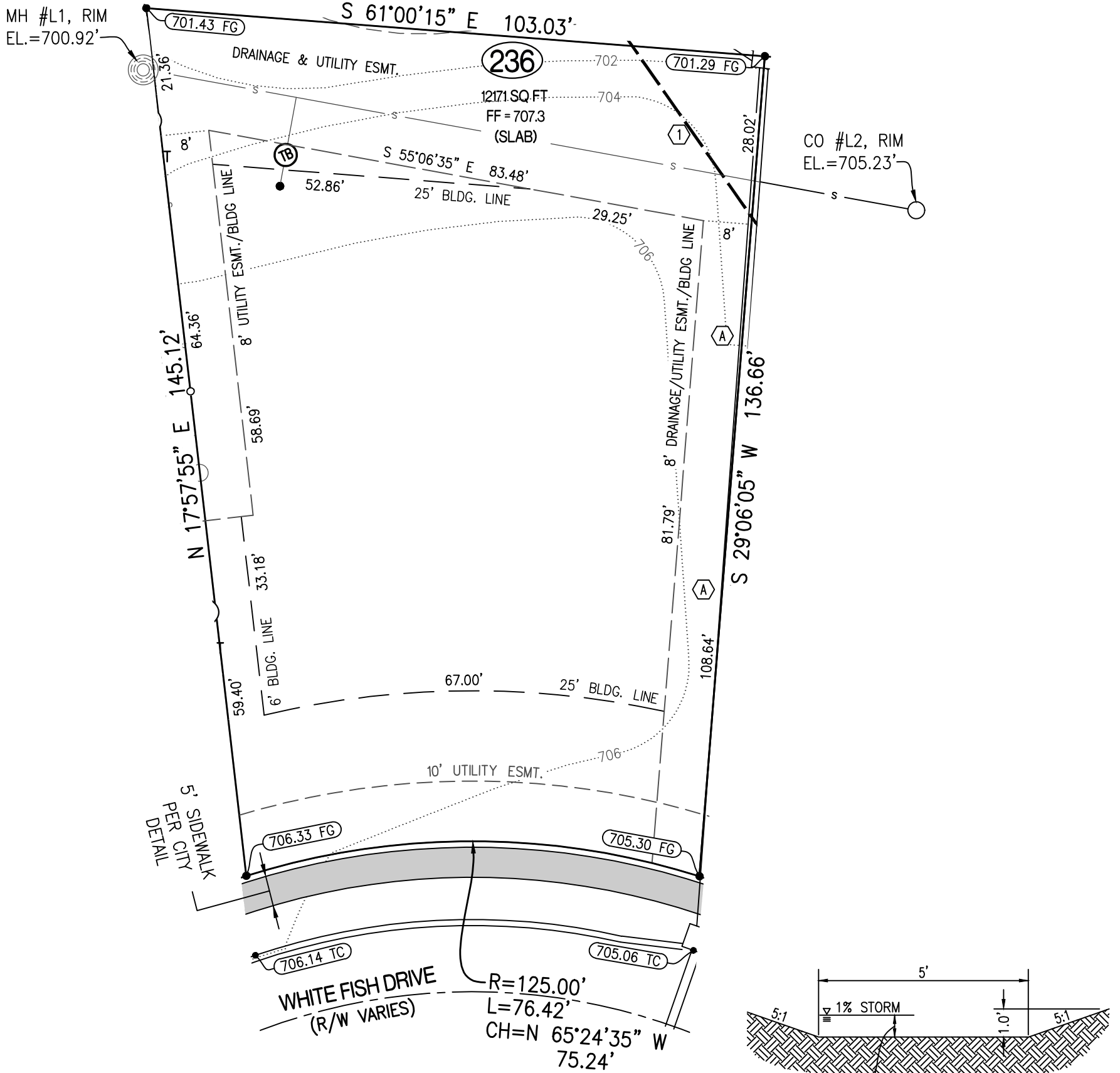

### CERTIFICATION:

I HEREBY CERTIFY THAT THE ABOVE LOT WAS SURVEYED UNDER MY DIRECTION. I FURTHER STATE THAT THE ABOVE LOT DOES NOT LIE WITHIN THE 100 YEAR FLOOD PLAIN AS ADOPTED BY THE CITY OF COLUMBIA, MISSOURI.



DAVID T. BUTCHER, PLS-2002014095  
6/2/2021  
DATE

### LEGEND:

- 1/2" IRON PIPE
- ⊕ PERMANENT MONUMENT
- (R) RADIAL LINE
- S— PROPOSED SANITARY SEWER
- PROPOSED LOCATION OF SEWER LATERAL
- ⊙ PROPOSED SAN. SEWER MANHOLE BASED ON DESIGN PLAN
- (XXX.XX TC) PROPOSED TOP OF CURB EL. BASED ON DESIGN PLAN
- FF = XXX.X MINIMUM FINISHED FLOOR
- Ⓟ TRACER BOX

### DESCRIPTION:

LOT 236 OF BRECKENRIDGE PARK, PLAT No. 2, RECORDED IN PLAT BOOK 55, PAGE 32, LOCATED IN COLUMBIA, BOONE COUNTY, MISSOURI.

**CROCKETT**  
ENGINEERING CONSULTANTS  
1000 W. Nifong Blvd., Building 1  
Columbia, Missouri 65203  
(573) 447-0292  
www.crockettengineering.com

CORPORATE NUMBER: 2000151304	
DATE: 5/8/2021	SCALE: 1" = 20'
PROJECT: 140213	DRAWN BY: KWF

<b>BRECKENRIDGE PARK, PLAT No. 2</b>
PLOT PLAN LOT 236 SEC 17 - T 48N - R 13W COLUMBIA, BOONE COUNTY, MISSOURI
ADDRESS:

