

# PLOT PLAN

## LOT 809

MH #C1, RIM  
EL.=745.17'

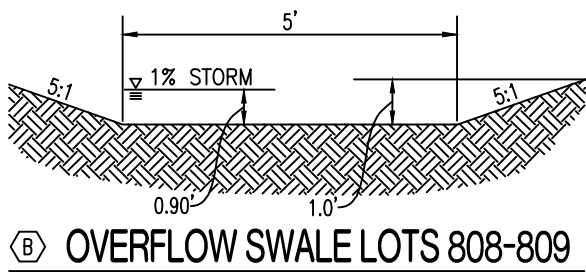
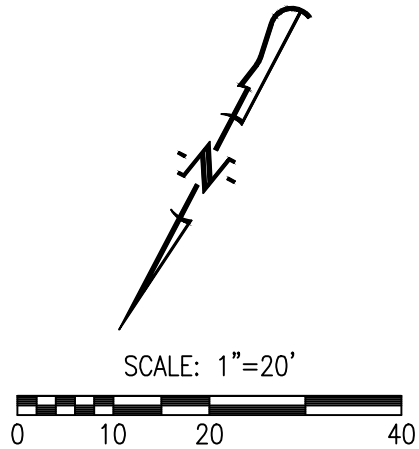

### CERTIFICATION:

I HEREBY CERTIFY THAT THE ABOVE LOT WAS SURVEYED UNDER MY DIRECTION. I FURTHER STATE THAT THE ABOVE LOT DOES NOT LIE WITHIN THE 100 YEAR FLOOD PLAIN AS ADOPTED BY THE CITY OF COLUMBIA, MISSOURI.

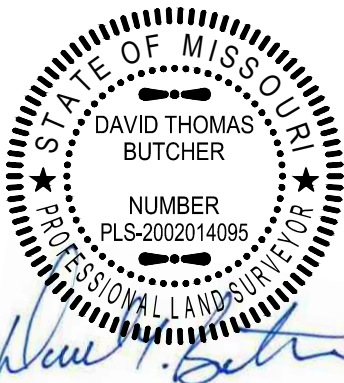

DAVID T. BUTCHER, PLS-2002014095  
11/16/2020  
DATE

### LEGEND:

- 1/2" IRON PIPE
- PERMANENT MONUMENT
- (R) RADIAL LINE
- S— PROPOSED SANITARY SEWER
- PROPOSED LOCATION OF SEWER LATERAL
- PROPOSED SAN. SEWER MANHOLE BASED ON DESIGN PLAN
- (XXX.XX TC) PROPOSED TOP OF CURB EL. BASED ON DESIGN PLAN
- FF=XXX.X MINIMUM FINISHED FLOOR
- Ⓟ TRACER BOX

### DESCRIPTION:

LOT 809 OF THE VINEYARDS, PLAT No. 8, RECORDED IN PLAT BOOK 54, PAGE 55, LOCATED IN COLUMBIA, BOONE COUNTY, MISSOURI.

**CROCKETT**  
ENGINEERING CONSULTANTS

1000 W. Nifong Blvd., Building 1  
Columbia, Missouri 65203  
(573) 447-0292

www.crockettengineering.com

CORPORATE NUMBER:  
2000151304

DATE:  
2/20/2020

PROJECT:  
041371

SCALE:  
1" = 20'

DRAWN BY:  
NMD

**THE VINEYARDS, PLAT No. 8**

PLOT PLAN  
LOT 809

NW QUARTER SEC 22- T 48 N - R 12 W  
COLUMBIA, BOONE COUNTY, MISSOURI

ADDRESS: