

PLOT PLAN LOT 619

DESCRIPTION:

LOT 619 OF THE GATES, PLAT No. 6,
RECORDED IN PLAT BOOK 54, PAGE 80,
LOCATED IN COLUMBIA, BOONE COUNTY,
MISSOURI.

CERTIFICATION:

I HEREBY CERTIFY THAT THE ABOVE LOT WAS SURVEYED
UNDER MY DIRECTION. I FURTHER STATE THAT THE
ABOVE LOT DOES NOT LIE WITHIN THE 100 YEAR FLOOD
PLAIN AS ADOPTED BY THE CITY OF COLUMBIA, MISSOURI.

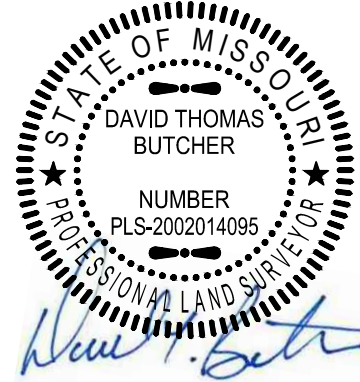

David T. Butcher

DAVID T. BUTCHER, PLS-2002014095
12/14/2020
DATE

619
230226 SQ FT
FF = 636.2
BSMT = 626.2
(WALKOUT)

LEGEND:

- 1/2" IRON PIPE
- ⊕ PERMANENT MONUMENT
- (R) RADIAL LINE
- S— PROPOSED SANITARY SEWER
- PROPOSED LOCATION OF SEWER LATERAL
- ⊙ PROPOSED SAN. SEWER MANHOLE BASED ON DESIGN PLAN
- (XXX.XX TC) PROPOSED TOP OF CURB EL. BASED ON DESIGN PLAN
- FF = XXXX MINIMUM FINISHED FLOOR
- Ⓟ TRACER BOX

THE GATES, PLAT No. 6

PLOT PLAN
LOT 619
SEC. 10 - T 47 N, R 13 W
COLUMBIA, BOONE COUNTY, MISSOURI

CROCKETT
ENGINEERING CONSULTANTS

1000 W. Nifong Blvd., Building 1
Columbia, Missouri 65203
(573) 447-0292

www.crockettengineering.com

CORPORATE NUMBER:
2000151304

DATE:	SCALE:
10/15/2020	1" = 60'

PROJECT:	DRAWN BY:
130285	NMD

ADDRESS:

SCALE: 1"=60'

