

LEGEND:

- 1/2" IRON PIPE
- ⊕ PERMANENT MONUMENT
- (R) RADIAL LINE
- S— PROPOSED SANITARY SEWER
- PROPOSED LOCATION OF SEWER LATERAL
- ⊙ PROPOSED SAN. SEWER MANHOLE BASED ON DESIGN PLAN
- (XXX.XX TC) PROPOSED TOP OF CURB EL. BASED ON DESIGN PLAN
- FF = XXX.X MINIMUM FINISHED FLOOR
- Ⓟ TRACER BOX

CERTIFICATION:

I HEREBY CERTIFY THAT THE ABOVE LOT WAS SURVEYED UNDER MY DIRECTION. I FURTHER STATE THAT THE ABOVE LOT DOES NOT LIE WITHIN THE 100 YEAR FLOOD PLAIN AS ADOPTED BY THE CITY OF COLUMBIA, MISSOURI.

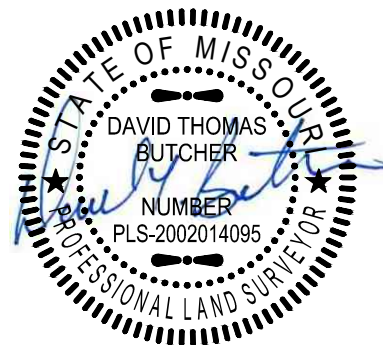
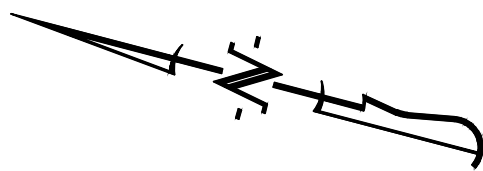

DESCRIPTION:

LOT 425 OF THE GATES PLAT 4, RECORDED IN PLAT BOOK 52, PAGE 5, LOCATED IN COLUMBIA, BOONE COUNTY, MISSOURI.

SCALE: 1"=20'

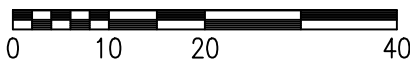

DAVID T. BUTCHER, PLS-2002014095
11/15/2019
DATE

CROCKETT
ENGINEERING CONSULTANTS
1000 W. Nifong Blvd. Building 1
Columbia, Missouri 65203
(573) 447-0292
www.crockettengineering.com

| | | |
|---------------------------------|--------------------|---|
| CORPORATE NUMBER: 2000151304 | | THE GATES, PLAT NO. 4 |
| DATE: 06/16/2017 | SCALE: 1" = 20' | |
| PROJECT: 130285 | DRAWN BY: KGL | PLOT PLAN LOT 425 SEC. 10, TOWNSHIP 47 NORTH, RANGE 13 WEST COLUMBIA, BOONE COUNTY, MISSOURI |
| | | ADDRESS: |