

LEGEND:

- 1/2" IRON PIPE
- PERMANENT MONUMENT
- (R) RADIAL LINE
- S— PROPOSED SANITARY SEWER
- PROPOSED LOCATION OF SEWER LATERAL
- ⊙ PROPOSED SAN. SEWER MANHOLE BASED ON DESIGN PLAN
- (XXX.XX TC) PROPOSED TOP OF CURB EL. BASED ON DESIGN PLAN
- FF = XXX.X MINIMUM FINISHED FLOOR
- Ⓟ TRACER BOX

CERTIFICATION:

I HEREBY CERTIFY THAT THE ABOVE LOT WAS SURVEYED UNDER MY DIRECTION. I FURTHER STATE THAT THE ABOVE LOT DOES NOT LIE WITHIN THE 100 YEAR FLOOD PLAIN AS ADOPTED BY THE CITY OF COLUMBIA, MISSOURI.

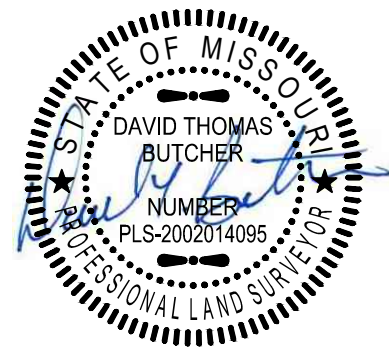

DAVID T. BUTCHER, PLS-2002014095
11/15/2019
DATE

DESCRIPTION:

LOT 410 OF THE GATES PLAT 4,
RECORDED IN PLAT BOOK 52, PAGE 5,
LOCATED IN COLUMBIA, BOONE COUNTY,
MISSOURI.

CROCKETT
ENGINEERING CONSULTANTS
1000 W. Nifong Blvd. Building 1
Columbia, Missouri 65203
(573) 447-0292
www.crockettengineering.com

CORPORATE NUMBER: 2000151304		THE GATES, PLAT NO. 4
DATE: 06/16/2017	SCALE: 1" = 20'	
PROJECT: 130285	DRAWN BY: KGL	PLOT PLAN LOT 410 SEC. 10, TOWNSHIP 47 NORTH, RANGE 13 WEST COLUMBIA, BOONE COUNTY, MISSOURI
		ADDRESS: