

LEGEND:

- 1/2" IRON PIPE
- ⊙ PERMANENT MONUMENT
- (R) RADIAL LINE
- S— PROPOSED SANITARY SEWER
- PROPOSED LOCATION OF SEWER LATERAL
- ⊙ PROPOSED SAN. SEWER MANHOLE BASED ON DESIGN PLAN
- (XXX.XX TC) PROPOSED TOP OF CURB EL. BASED ON DESIGN PLAN
- FF = XXXX MINIMUM FINISHED FLOOR
- Ⓟ TRACER BOX

DESCRIPTION:

LOT 713 OF VINEYARDS PLAT No. 7, RECORDED IN PLAT BOOK 51, PAGE 97, LOCATED IN COLUMBIA, BOONE COUNTY, MISSOURI.

CERTIFICATION:

I HEREBY CERTIFY THAT THE ABOVE LOT WAS SURVEYED UNDER MY DIRECTION. I FURTHER STATE THAT THE ABOVE LOT DOES NOT LIE WITHIN THE 100 YEAR FLOOD PLAIN AS ADOPTED BY THE CITY OF COLUMBIA, MISSOURI.

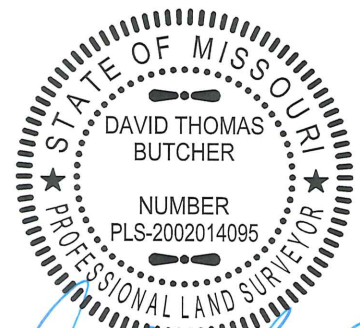
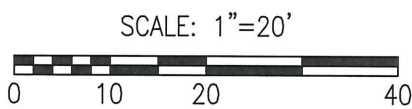
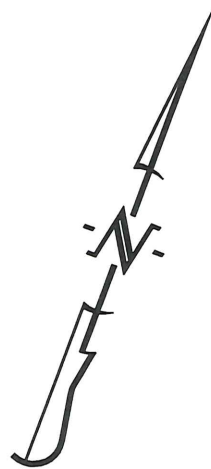

David T. Butcher
 DAVID T. BUTCHER, PLS-2002014095

3/12/18
 DATE

CROCKETT
ENGINEERING CONSULTANTS
 1000 W. Nifong Blvd. Building 1
 Columbia, Missouri 65203
 (573) 447-0292
 www.crockettengineering.com

CORPORATE NUMBER: 2000151304	
DATE: 11/01/2017	SCALE: 1" = 20'
PROJECT: 041371	DRAWN BY: KGL

THE VINEYARDS, PLAT No. 7
PLOT PLAN LOT 713
SECTION 21, TOWNSHIP 48 NORTH, RANGE 12 WEST COLUMBIA, BOONE COUNTY, MISSOURI
ADDRESS: