

**LEGEND:**

- 1/2" IRON PIPE
- PERMANENT MONUMENT
- (R) RADIAL LINE
- S— PROPOSED SANITARY SEWER
- PROPOSED LOCATION OF SEWER LATERAL
- ⊙ PROPOSED SAN. SEWER MANHOLE BASED ON DESIGN PLAN
- ⊙(XXX.XX TC) PROPOSED TOP OF CURB EL. BASED ON DESIGN PLAN
- FF = XXXX MINIMUM FINISHED FLOOR
- Ⓟ TRACER BOX

**DESCRIPTION:**

LOT 712 OF VINEYARDS PLAT No. 7, RECORDED IN PLAT BOOK 51, PAGE 97, LOCATED IN COLUMBIA, BOONE COUNTY, MISSOURI.

**CERTIFICATION:**

I HEREBY CERTIFY THAT THE ABOVE LOT WAS SURVEYED UNDER MY DIRECTION. I FURTHER STATE THAT THE ABOVE LOT DOES NOT LIE WITHIN THE 100 YEAR FLOOD PLAIN AS ADOPTED BY THE CITY OF COLUMBIA, MISSOURI.

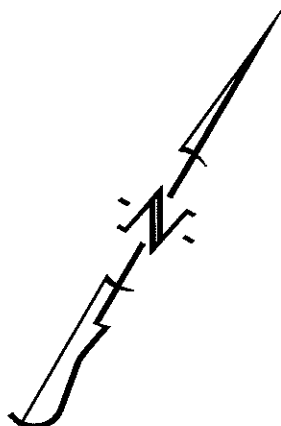

SCALE: 1"=20'

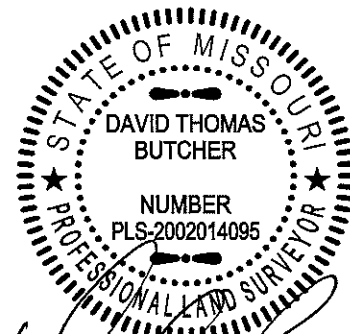

*David T. Butcher*  
 DAVID T. BUTCHER, PLS-2002014095  
 7/23/2019  
 DATE

**CROCKETT**  
**ENGINEERING CONSULTANTS**  
 1000 W. Nifong Blvd. Building 1  
 Columbia, Missouri 65203  
 (573) 447-0292  
 www.crockettengineering.com

CORPORATE NUMBER: 2000151304	
DATE: 7/23/2019	SCALE: 1" = 20'
PROJECT: 041371	DRAWN BY: KGL

<b>THE VINEYARDS, PLAT No. 7</b>
PLOT PLAN LOT 712 SECTION 21, TOWNSHIP 48 NORTH, RANGE 12 WEST COLUMBIA, BOONE COUNTY, MISSOURI
ADDRESS: