

**LEGEND:**

- 1/2" IRON PIPE
- ⊕ PERMANENT MONUMENT
- (R) RADIAL LINE
- S— PROPOSED SANITARY SEWER
- PROPOSED LOCATION OF SEWER LATERAL
- ⊙ PROPOSED SAN. SEWER MANHOLE BASED ON DESIGN PLAN
- (XXX.XX TC) PROPOSED TOP OF CURB EL. BASED ON DESIGN PLAN
- FF=XXX.X MINIMUM FINISHED FLOOR
- Ⓟ TRACER BOX

**DESCRIPTION:**

LOT 709 OF VINEYARDS PLAT No. 7,  
RECORDED IN PLAT BOOK 51, PAGE  
97, LOCATED IN COLUMBIA, BOONE  
COUNTY, MISSOURI.

**CERTIFICATION:**

I HEREBY CERTIFY THAT THE ABOVE LOT WAS SURVEYED  
UNDER MY DIRECTION. I FURTHER STATE THAT THE ABOVE  
LOT DOES NOT LIE WITHIN THE 100 YEAR FLOOD PLAIN AS  
ADOPTED BY THE CITY OF COLUMBIA, MISSOURI.



SCALE: 1"=20'

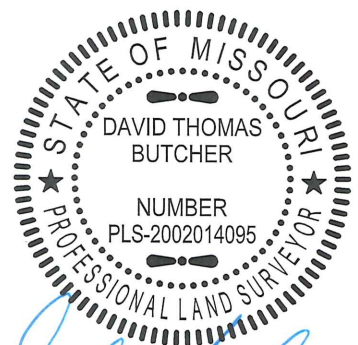

DAVID T. BUTCHER, PLS-2002014095

DATE

**CROCKETT**  
ENGINEERING CONSULTANTS

1000 W. Nifong Blvd. Building 1  
Columbia, Missouri 65203  
(573) 447-0292

www.crockettengineering.com

CORPORATE NUMBER:  
2000151304

DATE:  
11/01/2017

PROJECT:  
041371

SCALE:  
1" = 20'

DRAWN BY:  
KGL

**THE VINEYARDS, PLAT No. 7**

PLOT PLAN  
LOT 709

SECTION 21, TOWNSHIP 48 NORTH, RANGE 12 WEST  
COLUMBIA, BOONE COUNTY, MISSOURI

ADDRESS: