

LEGEND:

- 1/2" IRON PIPE
- PERMANENT MONUMENT
- (R) RADIAL LINE
- S— PROPOSED SANITARY SEWER
- PROPOSED LOCATION OF SEWER LATERAL
- PROPOSED SAN. SEWER MANHOLE BASED ON DESIGN PLAN
- (XXX.XX TC) PROPOSED TOP OF CURB EL. BASED ON DESIGN PLAN
- FF=XXX.X MINIMUM FINISHED FLOOR
- Ⓟ TRACER BOX

DESCRIPTION:

LOT 708 OF VINEYARDS PLAT No. 7,
RECORDED IN PLAT BOOK 51, PAGE
97, LOCATED IN COLUMBIA, BOONE
COUNTY, MISSOURI.

CERTIFICATION:

I HEREBY CERTIFY THAT THE ABOVE LOT WAS SURVEYED
UNDER MY DIRECTION. I FURTHER STATE THAT THE ABOVE
LOT DOES NOT LIE WITHIN THE 100 YEAR FLOOD PLAIN AS
ADOPTED BY THE CITY OF COLUMBIA, MISSOURI.

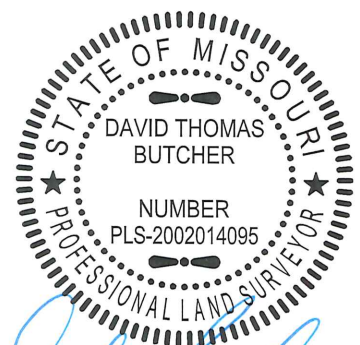
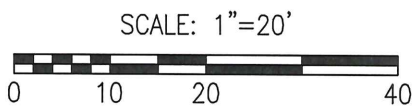

DAVID T. BUTCHER, PLS-2002014095
3/12/18
DATE

CROCKETT
ENGINEERING CONSULTANTS
1000 W. Nifong Blvd. Building 1
Columbia, Missouri 65203
(573) 447-0292
www.crockettengineering.com

CORPORATE NUMBER: 2000151304		THE VINEYARDS, PLAT No. 7	
DATE: 11/01/2017	SCALE: 1" = 20'	PLOT PLAN LOT 708	
PROJECT: 041371	DRAWN BY: KGL	SECTION 21, TOWNSHIP 48 NORTH, RANGE 12 WEST COLUMBIA, BOONE COUNTY, MISSOURI	
		ADDRESS:	