

LEGEND:

- 1/2" IRON PIPE
- PERMANENT MONUMENT
- (R) RADIAL LINE
- S— PROPOSED SANITARY SEWER
- PROPOSED LOCATION OF SEWER LATERAL
- ⊙ PROPOSED SAN. SEWER MANHOLE BASED ON DESIGN PLAN
- (XXX.XX TC) PROPOSED TOP OF CURB EL. BASED ON DESIGN PLAN
- FF = XXX.X MINIMUM FINISHED FLOOR

DESCRIPTION:

LOT 334 OF THE VINEYARDS PLAT No. 3, RECORDED IN PLAT BOOK 50, PAGE 67, LOCATED IN COLUMBIA, BOONE COUNTY, MISSOURI.

CERTIFICATION:

I HEREBY CERTIFY THAT THE ABOVE LOT WAS SURVEYED UNDER MY DIRECTION. I FURTHER STATE THAT THE ABOVE LOT DOES NOT LIE WITHIN THE 100 YEAR FLOOD PLAIN AS ADOPTED BY THE CITY OF COLUMBIA, MISSOURI.

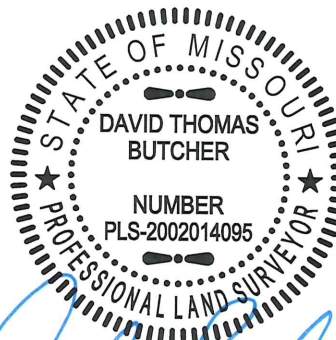

DAVID T. BUTCHER, PLS-2002014095
11/12/2017
DATE

CROCKETT
ENGINEERING CONSULTANTS
1000 W. Nifong Blvd., Building 1
Columbia, Missouri 65203
(573) 447-0292
www.crockettengineering.com

CORPORATE NUMBER:
2000151304
DATE:
11/14/2016
SCALE:
1" = 20'
PROJECT:
041371
DRAWN BY:
KWF

THE VINEYARDS, PLAT No. 3

PLOT PLAN
LOT 334
SECTION 21, TOWNSHIP 48 NORTH, RANGE 12 WEST
COLUMBIA, BOONE COUNTY, MISSOURI
ADDRESS: