

LEGEND:

- 1/2" IRON PIPE
- ⊕ PERMANENT MONUMENT
- (R) RADIAL LINE
- S— PROPOSED SANITARY SEWER
- PROPOSED LOCATION OF SEWER LATERAL
- ⊙ PROPOSED SAN. SEWER MANHOLE BASED ON DESIGN PLAN
- (XXX.XX TC) PROPOSED TOP OF CURB EL. BASED ON DESIGN PLAN
- FF = XXXX MINIMUM FINISHED FLOOR

DESCRIPTION:

LOT 331 OF THE VINEYARDS PLAT No. 3, RECORDED IN PLAT BOOK 50, PAGE 67, LOCATED IN COLUMBIA, BOONE COUNTY, MISSOURI.

CERTIFICATION:

I HEREBY CERTIFY THAT THE ABOVE LOT WAS SURVEYED UNDER MY DIRECTION. I FURTHER STATE THAT THE ABOVE LOT DOES NOT LIE WITHIN THE 100 YEAR FLOOD PLAIN AS ADOPTED BY THE CITY OF COLUMBIA, MISSOURI.

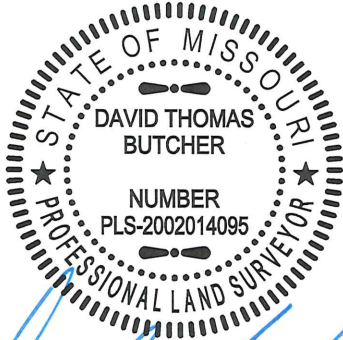

DAVID T. BUTCHER, PLS-2002014095
1/19/2017
DATE

CROCKETT ENGINEERING CONSULTANTS 1000 W. Nifong Blvd., Building 1 Columbia, Missouri 65203 (573) 447-0292 www.crockettengineering.com	CORPORATE NUMBER: 2000151304		THE VINEYARDS, PLAT No. 3	
	DATE: 12/09/2016	SCALE: 1" = 20'	PLOT PLAN LOT 331	
	PROJECT: 041371	DRAWN BY: KWF	SECTION 21, TOWNSHIP 48 NORTH, RANGE 12 WEST COLUMBIA, BOONE COUNTY, MISSOURI	
			ADDRESS:	