

**DESCRIPTION:**

LOT 312 OF THE VINEYARDS PLAT No. 3, RECORDED IN PLAT BOOK 50, PAGE 67, LOCATED IN COLUMBIA, BOONE COUNTY, MISSOURI.

**CERTIFICATION:**

I HEREBY CERTIFY THAT THE ABOVE LOT WAS SURVEYED UNDER MY DIRECTION. I FURTHER STATE THAT THE ABOVE LOT DOES NOT LIE WITHIN THE 100 YEAR FLOOD PLAIN AS ADOPTED BY THE CITY OF COLUMBIA, MISSOURI.

**LEGEND:**

- 1/2" IRON PIPE
- ⊕ PERMANENT MONUMENT
- (R) RADIAL LINE
- S— PROPOSED SANITARY SEWER
- PROPOSED LOCATION OF SEWER LATERAL
- ⊙ PROPOSED SAN. SEWER MANHOLE BASED ON DESIGN PLAN
- (XXX.XX TC) PROPOSED TOP OF CURB EL. BASED ON DESIGN PLAN
- FF = XXX.X MINIMUM FINISHED FLOOR

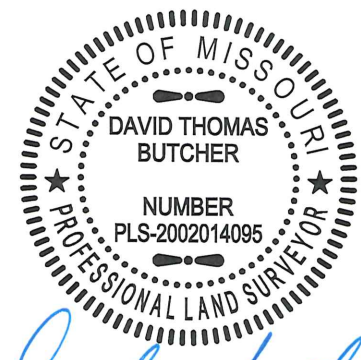

*David T. Butcher*  
 DAVID T. BUTCHER, PLS-2002014095  
 12/14/2016  
 DATE

**CROCKETT**  
**ENGINEERING CONSULTANTS**  
 2608 North Stadium Boulevard  
 Columbia, Missouri 65202  
 (573) 447-0292  
 www.crockettengineering.com

CORPORATE NUMBER: 2000151304	
DATE: 12/09/2016	SCALE: 1" = 20'
PROJECT: 041371	DRAWN BY: KWF

<b>THE VINEYARDS, PLAT No. 3</b>
PLOT PLAN LOT 312 SECTION 21, TOWNSHIP 48 NORTH, RANGE 12 WEST COLUMBIA, BOONE COUNTY, MISSOURI
ADDRESS: