

#### LEGEND:

- 1/2" IRON PIPE
- ⊕ PERMANENT MONUMENT
- (R) RADIAL LINE
- S— PROPOSED SANITARY SEWER
- PROPOSED LOCATION OF SEWER LATERAL
- ⊙ PROPOSED SAN. SEWER MANHOLE BASED ON DESIGN PLAN
- (XXX.XX TC) PROPOSED TOP OF CURB EL. BASED ON DESIGN PLAN
- FF = XXX.X MINIMUM FINISHED FLOOR
- Ⓟ TRACER BOX

#### DESCRIPTION:

LOT 157 OF BRECKENRIDGE PARK PLAT NO. 1, RECORDED IN PLAT BOOK 51, PAGE 80, LOCATED IN COLUMBIA, BOONE COUNTY, MISSOURI.

#### CERTIFICATION:

I HEREBY CERTIFY THAT THE ABOVE LOT WAS SURVEYED UNDER MY DIRECTION. I FURTHER STATE THAT THE ABOVE LOT DOES NOT LIE WITHIN THE 100 YEAR FLOOD PLAIN AS ADOPTED BY THE CITY OF COLUMBIA, MISSOURI.

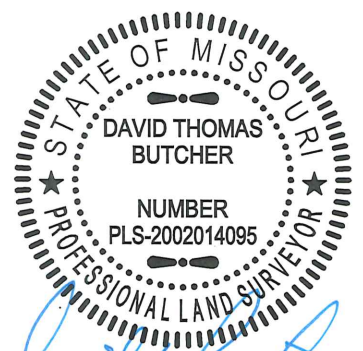
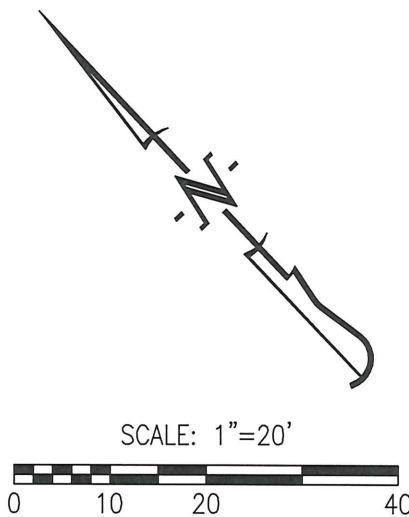

DAVID T. BUTCHER, PLS-2002014095  
2/14/2018  
DATE

**CROCKETT**  
ENGINEERING CONSULTANTS  
1000 W. Nifong Blvd. Building 1  
Columbia, Missouri 65203  
(573) 447-0292  
www.crockettengineering.com

CORPORATE NUMBER: 2000151304		BRECKENRIDGE PARK PLAT NO.1	
DATE: 07/28/17	SCALE: 1" = 20'	PLOT PLAN LOT 157 SEC. 17, T48N, R13W COLUMBIA, BOONE COUNTY, MISSOURI	
PROJECT: 140213	DRAWN BY: KGL		
		ADDRESS:	