

LEGEND:

- 1/2" IRON PIPE
- PERMANENT MONUMENT
- (R) RADIAL LINE
- S— PROPOSED SANITARY SEWER
- PROPOSED LOCATION OF SEWER LATERAL
- ⊙ PROPOSED SAN. SEWER MANHOLE BASED ON DESIGN PLAN
- (XXX.XX TC) PROPOSED TOP OF CURB EL. BASED ON DESIGN PLAN
- FF = XXX.X MINIMUM FINISHED FLOOR
- Ⓟ TRACER BOX

DESCRIPTION:

LOT 144 OF BRECKENRIDGE PARK PLAT NO. 1, RECORDED IN PLAT BOOK 51, PAGE 80, LOCATED IN COLUMBIA, BOONE COUNTY, MISSOURI.

CERTIFICATION:

I HEREBY CERTIFY THAT THE ABOVE LOT WAS SURVEYED UNDER MY DIRECTION. I FURTHER STATE THAT THE ABOVE LOT DOES NOT LIE WITHIN THE 100 YEAR FLOOD PLAIN AS ADOPTED BY THE CITY OF COLUMBIA, MISSOURI.



SCALE: 1"=20'

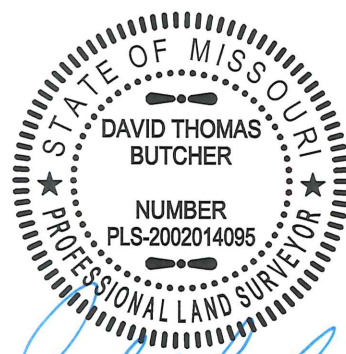
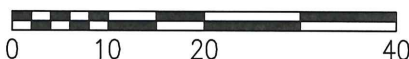

DAVID T. BUTCHER, PLS-2002014095

DATE

CROCKETT
ENGINEERING CONSULTANTS

1000 W. Nifong Blvd. Building 1
Columbia, Missouri 65203
(573) 447-0292

www.crockettengineering.com

CORPORATE NUMBER:
2000151304

DATE: 07/28/17
SCALE: 1" = 20'

PROJECT: 140213
DRAWN BY: KGL

BRECKENRIDGE PARK PLAT NO. 1

PLOT PLAN
LOT 144
SEC. 17, T48N, R13W
COLUMBIA, BOONE COUNTY, MISSOURI

ADDRESS: