

**LEGEND:**

- 1/2" IRON PIPE
- ⊕ PERMANENT MONUMENT
- (R) RADIAL LINE
- S— PROPOSED SANITARY SEWER
- PROPOSED LOCATION OF SEWER LATERAL
- ⊙ PROPOSED SAN. SEWER MANHOLE BASED ON DESIGN PLAN
- (XXX.XX TC) PROPOSED TOP OF CURB EL. BASED ON DESIGN PLAN
- FF = XXX.X MINIMUM FINISHED FLOOR
- Ⓟ TRACER BOX

**DESCRIPTION:**

LOT 144 OF BRECKENRIDGE PARK PLAT NO. 1, RECORDED IN PLAT BOOK 51, PAGE 80, LOCATED IN COLUMBIA, BOONE COUNTY, MISSOURI.

**CERTIFICATION:**

I HEREBY CERTIFY THAT THE ABOVE LOT WAS SURVEYED UNDER MY DIRECTION. I FURTHER STATE THAT THE ABOVE LOT DOES NOT LIE WITHIN THE 100 YEAR FLOOD PLAIN AS ADOPTED BY THE CITY OF COLUMBIA, MISSOURI.

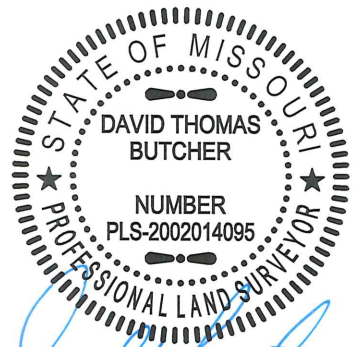
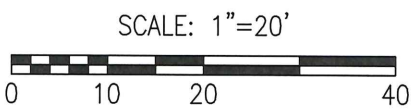

DAVID T. BUTCHER, PLS-2002014095  
 2/14/2018  
 DATE

**CROCKETT**  
**ENGINEERING CONSULTANTS**  
 1000 W. Nifong Blvd. Building 1  
 Columbia, Missouri 65203  
 (573) 447-0292  
 www.crockettengineering.com

CORPORATE NUMBER: 2000151304	
DATE: 07/28/17	SCALE: 1" = 20'
PROJECT: 140213	DRAWN BY: KGL

<b>BRECKENRIDGE PARK PLAT NO. 1</b>	
PLOT PLAN LOT 144 SEC. 17, T48N, R13W COLUMBIA, BOONE COUNTY, MISSOURI	
ADDRESS:	