

RED FEATHER CT.  
(50' R/W)

#### LEGEND:

- 1/2" IRON PIPE
- PERMANENT MONUMENT
- (R) RADIAL LINE
- S— PROPOSED SANITARY SEWER
- PROPOSED LOCATION OF SEWER LATERAL
- ⊙ PROPOSED SAN. SEWER MANHOLE BASED ON DESIGN PLAN
- (XXX.XX TO) PROPOSED TOP OF CURB EL. BASED ON DESIGN PLAN
- FF = XXX.X MINIMUM FINISHED FLOOR
- Ⓟ TRACER BOX

#### DESCRIPTION:

LOT 124 OF BRECKENRIDGE PARK PLAT NO. 1, RECORDED IN PLAT BOOK 51, PAGE 80, LOCATED IN COLUMBIA, BOONE COUNTY, MISSOURI.

#### CERTIFICATION:

I HEREBY CERTIFY THAT THE ABOVE LOT WAS SURVEYED UNDER MY DIRECTION. I FURTHER STATE THAT THE ABOVE LOT DOES NOT LIE WITHIN THE 100 YEAR FLOOD PLAIN AS ADOPTED BY THE CITY OF COLUMBIA, MISSOURI.

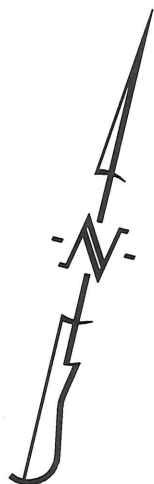

SCALE: 1"=20'

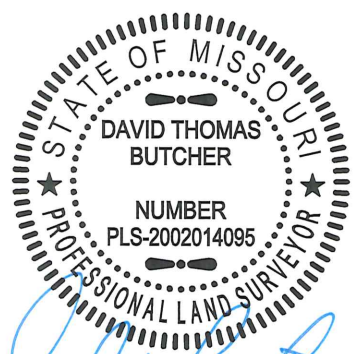
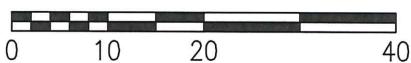

DAVID T. BUTCHER, PLS-2002014095

2/14/2018  
DATE

**CROCKETT**  
ENGINEERING CONSULTANTS

1000 W. Nifong Blvd. Building 1.  
Columbia, Missouri 65203  
(573) 447-0292

www.crockettengineering.com

CORPORATE NUMBER:  
2000151304

DATE:

07/28/17

SCALE:

1" = 20'

PROJECT:

140213

DRAWN BY:

KGL

**BRECKENRIDGE PARK PLAT NO. 1**

PLOT PLAN

LOT 124

SEC. 17, T48N, R13W

COLUMBIA, BOONE COUNTY, MISSOURI

ADDRESS: