

PLOT PLAN

LOT 213

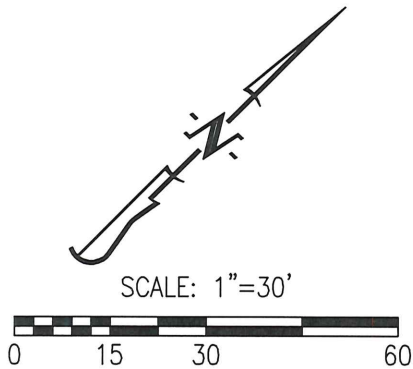

LEGEND:

- 1/2" IRON PIPE
- ⊕ PERMANENT MONUMENT
- (R) RADIAL LINE
- S— PROPOSED SANITARY SEWER
- PROPOSED LOCATION OF SEWER LATERAL
- (XXX.XX TC) PROPOSED TOP OF CURB EL. BASED ON DESIGN PLAN
- FF = XXX.X MINIMUM FINISHED FLOOR

CERTIFICATION:

I HEREBY CERTIFY THAT THE ABOVE LOT WAS SURVEYED UNDER MY DIRECTION. I FURTHER STATE THAT THE ABOVE LOT DOES NOT LIE WITHIN THE 100 YEAR FLOOD PLAIN AS ADOPTED BY THE CITY OF COLUMBIA, MISSOURI.

DESCRIPTION:

LOT 213 OF THE GATES, PLAT NO. 2 & 3, RECORDED IN PLAT BOOK 49, PAGE 29, LOCATED IN COLUMBIA, BOONE COUNTY, MISSOURI.

PREPARED BY:

CROCKETT
ENGINEERING CONSULTANTS
www.crockettengineering.com

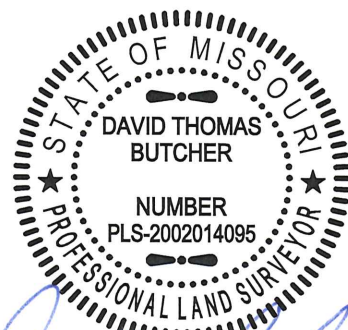

David T. Butcher
DAVID T. BUTCHER, PLS-2002014095
3/2/2016
DATE