

PLOT PLAN

LOT 638

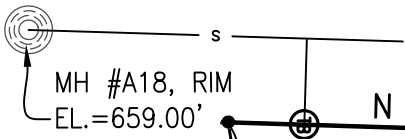

N 1°02'30" E 64.69'

662.48 FG

670.37 FG

638

15801 SQ FT
FF = 681.3
BSMT.=671.3
(WALKOUT)

47.74' 25' BLDG. LINE

N 88°57'30" W 43.61'

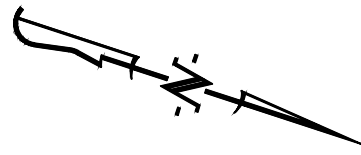

SCALE: 1"=20'

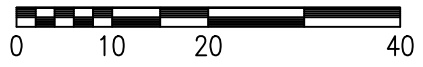

S 80°05'20" W(R) 204.23'

6' BLDG. LINE

152.53'

132.85'

N 51°23'15" E(R) 135.00'

6' BLDG. LINE

25' BLDG. LINE

10' UTILITY ESMT.

100.71'

680.84 FG

680.42 TC

R=250.00'
L=125.23'
CH=N 24°15'40" W
123.93'

RIVINGTON DR.
(50' R/W)

676.23 FG

676.00 TC

5' SIDEWALK
PER CITY
DETAIL

CERTIFICATION:

I HEREBY CERTIFY THAT THE ABOVE LOT WAS SURVEYED UNDER MY DIRECTION. I FURTHER STATE THAT THE ABOVE LOT DOES NOT LIE WITHIN THE 100 YEAR FLOOD PLAIN AS ADOPTED BY THE CITY OF COLUMBIA, MISSOURI.

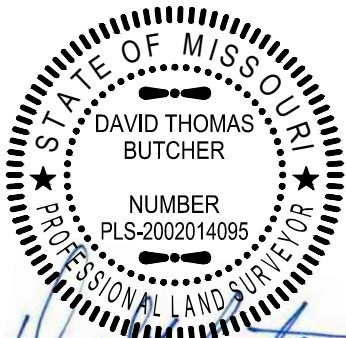

David T. Butcher

DAVID T. BUTCHER, PLS-2002014095
12/14/2020
DATE

DESCRIPTION:

LOT 638 OF THE GATES, PLAT No. 6, RECORDED IN PLAT BOOK 54, PAGE 80, LOCATED IN COLUMBIA, BOONE COUNTY, MISSOURI.

LEGEND:

- 1/2" IRON PIPE
- ⊕ PERMANENT MONUMENT
- (R) RADIAL LINE
- S— PROPOSED SANITARY SEWER
- PROPOSED LOCATION OF SEWER LATERAL
- ⊙ PROPOSED SAN. SEWER MANHOLE BASED ON DESIGN PLAN
- (XXX.XX TC) PROPOSED TOP OF CURB EL. BASED ON DESIGN PLAN
- FF = XXX.X MINIMUM FINISHED FLOOR
- Ⓟ TRACER BOX

CROCKETT
ENGINEERING CONSULTANTS
1000 W. Nifong Blvd., Building 1
Columbia, Missouri 65203
(573) 447-0292
www.crockettengineering.com

CORPORATE NUMBER: 2000151304	
DATE: 10/15/2020	SCALE: 1" = 20'
PROJECT: 130285	DRAWN BY: NMD

THE GATES, PLAT No. 6	
PLOT PLAN LOT 638 SEC 10 - T 47N - R 13W COLUMBIA, BOONE COUNTY, MISSOURI	
ADDRESS:	