

# PLOT PLAN

## LOT 615

S 25°25'30" E 85.22'



SCALE: 1"=40'



### LEGEND:

- 1/2" IRON PIPE
- PERMANENT MONUMENT
- (R) RADIAL LINE
- S— PROPOSED SANITARY SEWER
- PROPOSED LOCATION OF SEWER LATERAL
- ⊙ PROPOSED SAN. SEWER MANHOLE BASED ON DESIGN PLAN
- (XXX.XX TC) PROPOSED TOP OF CURB EL. BASED ON DESIGN PLAN
- FF = XXX.X MINIMUM FINISHED FLOOR
- Ⓟ TRACER BOX

### DESCRIPTION:

LOT 615 OF THE GATES, PLAT No. 6, RECORDED IN PLAT BOOK 54, PAGE 80, LOCATED IN COLUMBIA, BOONE COUNTY, MISSOURI.

### CERTIFICATION:

I HEREBY CERTIFY THAT THE ABOVE LOT WAS SURVEYED UNDER MY DIRECTION. I FURTHER STATE THAT THE ABOVE LOT DOES NOT LIE WITHIN THE 100 YEAR FLOOD PLAIN AS ADOPTED BY THE CITY OF COLUMBIA, MISSOURI.

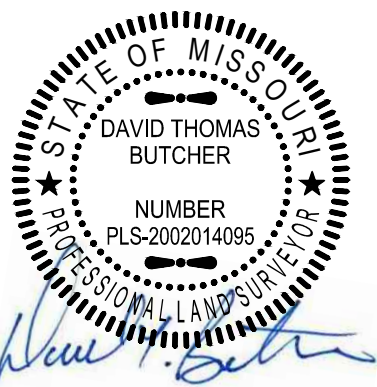

DAVID T. BUTCHER, PLS-2002014095

12/14/2020

DATE

## THE GATES, PLAT No. 6

PLOT PLAN  
LOT 615  
SEC. 10 - T 47 N, R 13 W  
COLUMBIA, BOONE COUNTY, MISSOURI

**CROCKETT**  
ENGINEERING CONSULTANTS

1000 W. Nifong Blvd., Building 1  
Columbia, Missouri 65203  
(573) 447-0292

www.crockettengineering.com

CORPORATE NUMBER:  
2000151304

DATE: 10/15/2020 SCALE: 1" = 40'

PROJECT: 130285 DRAWN BY: NMD

ADDRESS:

